

MINI-ROOTER

Parts List and Diagram

CATALOG NO.	DESCRIPTION	CATALOG NO.	DESCRIPTION
MR-100-1	Complete Frame Assembly	MR-260-1	Collet Chuck Assembly (Serial #23647 & Over)
MR-101-1	Frame Only	MR-280	Dual Drum (For 1/4", 5/16", and 3/8" diameter cables)
MR-102	Rubber Leg Tip (2)	MR-281	Container Front
MR-104	Shaft Retaining Pin	MR-281-A	Screws and Nuts (4)
MR-104-A	Retaining Pin Spring	MR-282	Container Back
MR-104-B	Retaining Pin Collar	MR-283	Chucking Assembly
MR-105	Shaft Spacer	MR-283-A	Chuck Body
MR-200	Complete Drum Assembly (Enclosed)	MR-283-B	Knurled Knob
MR-200-1	Drum with Modified Dist. Tube	MR-283-C	Spring
MR-200-2	Drum with Inner Drum Cage	MR-283-D	Screw
MR-200-O	Complete Drum Assy. (Open)	MR-284	Hub with Bushing (MR-201-A-2)
MR-201-2	Drum Shell (Ser. #21566 & Over)	MR-284-A	Nuts and Bolts (5)
MR-201-A-2	Rear Hub Assembly (Ser. #21566 & Over)	MR-285	Washer
MR-201-A-3	Rear Hub Assy. for Open Cage	MR-286	Shaft w/ Snap Rings & Washers
MR-201-C	Screws & Flanged Locknuts (5)	MR-286-A	Snap Rings (2)
MR-201-D	Rear Hub Bushing	MR-286-B	Steel Washer
MR-201-E	Retaining Screw	MR-286-C	Felt Washer
MR-201/202	Complete Shaft & Hub Assembly (Thru Serial #09199)	MR-287	Collar with Set Screw
MR-201/202-1	Comp. Shaft & Hub Assy. Disc. (Serial #09200 to #21565)	MR-291	Internal Container Front
MR-201/202-2	Complete Shaft & Hub Assembly (Serial #21566 & Over)	MR-292	Internal Container Back
MR-202	Shaft	MR-292-A	Nuts, Lockwashers & Thumb Nuts (4)
MR-202-A	Retaining Ring (2)	MR-293	Bevelled Collar
MR-202-B	Steel Washer	MR-300	Motor 1/3 hp with Ground Fault Interrupter, Ft. Sw. & Rev.Sw.
MR-202-C	Felt Washer	A-MR-300	Motor with Slip Clutch, GFI, Foot Switch & Reverse Switch
MR-203	Drum Front Only(See MR-201-2)	MR-301-A	10 ft. Cord with GFI
MR-203-B	Edging (2)	MR-301-B	Knob for Mounting Stud
MR-204-1	Distributor Tube	MR-303	V-Belt Pulley
MR-204-A	Distributor Tube Rear Collar with Set Screw	MR-303-1	Safety Clutch
MR-204-B	Distributor Tube Front Collar with Set Screw	MR-304-1	Motor Support with Bolts, Nuts, Washers (Ser. #08627 & Over)
MR-204-2	Distributor Tube & Inner Drum	MR-304-A	Guide Screws (2)
MR-205	Fiber Washer (2)	MR-305	Motor Support Spring
MR-206	Front Hub	MR-306	V-Belt (45")
MR-206-A	Front Hub Bushing	MR-307-1	V-Belt Guard With Velcro
MR-207	Round Head Cap Screw & Lockwashers (4)	MR-307-2	Belt Guard with Slot for Mounting Stud
MR-210	Drum Connecting Cable	MR-308	Foot Switch & Reverse Switch Assy. (Ser. # 14933 & Over)
MR-210-A	Conn. Cable Bolt, Nut & Washer	MR-308-A	Box Only w/Cover & Screws
MR-215	Distributor Tube Modification Kit	MR-308-B	Foot Pedal & Hose
MR-250	"J" Drum (For 1/4" & 5/16" Cables)	MR-308-C	Cable Tie
MR-251-1	Rear Shell (Ser. #21566 & Over)	MR-308-D	Foot Pedal Only
MR-255	Front Assy.-Jacobs Chuck Disc. (Thru Ser #23646)	MR-308-E	Power Switch Diaphragm
MR-255-1	Front Assembly for Collet Chuck (Serial #23647 & Over)	MR-308-F	Air Hose
MR-255-A	Spout Assy-Jacobs Chuck Disc. (Through Serial #23646)	MR-308-G	Reverse Switch (3-way)
MR-255-A-1	Spout Assembly for Collet Chuck (Serial #23647 & Over)	MR-308-H	Rubber Boot (Open Cage Units Only)
MR-255-B	Bushing	MR-308-J	Barbed Adapter
MR-257	Shaft for "J" Drum	MR-308-N	Strain Relief Nut
MR-260	Jacobs Chuck Assembly (Through Serial #23646)	GFI-MR	Ground Fault Circuit Interrupter
		MR-DECAL	Set of Safety Decals
		MR-VIDEO	Instructional Video
		PO-MR	Mini-Rooter Power Cable Feed
		MR-GT	Guide Tube
		EM3R8	Adapter

General Wire Spring Co.

1101 Thompson Avenue

412/771-6300

McKees Rocks, PA 15136 U.S.A.

MINI-ROOTER SCHEMATIC DIAGRAM

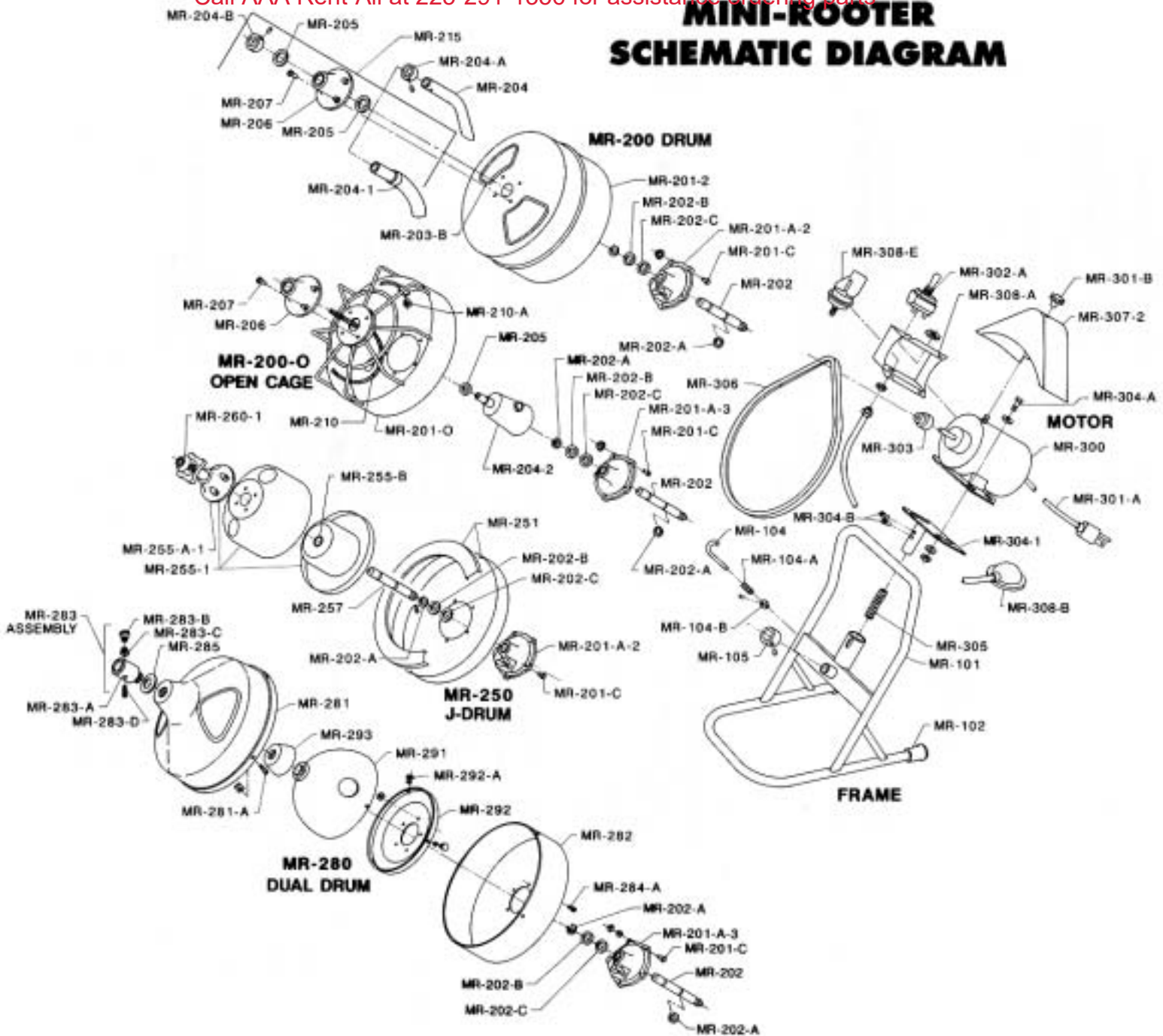

IMPORTANT: When ordering, give Serial Number of Machine.